

mackworth

M180 – Folding

Weights and dimensions

SWL	: 180 kg
Unit weight	: 39 kg
A (height)	: 1,340 – 1,970 mm
B (length)	: 1,310 mm
C (internal width)	: 540 – 1,030 mm
D (external width)	: 680 – 1,120 mm
E (ground clearance)	: 25 mm
F (under bed clearance)	: 112 mm
G (Carry bar height)	: 255 – 1,700 mm
Carry bar width	: 560 mm
Turning circle	: 1,010 mm
Castor size	: 100 mm

Details

Product code	: 1301MH-M180FOLD
Drawing number	: 107000
GS1 code	: 5056408920131
Warranty	: 2 years
Sling connection	: Looped
Lift	: Electric (LA34 – 10 kN)
Leg opening	: Manual
Duty cycle	: 15% use, 85% rest
Battery	: 24 V SLA, 2.9 Ah
Charging time	: 8 hours
Lifts per charge	: 30
IP rating (controls)	: IPX4
IP rating (battery)	: IPX5
Material	: Powdercoated steel, vinyl PVC

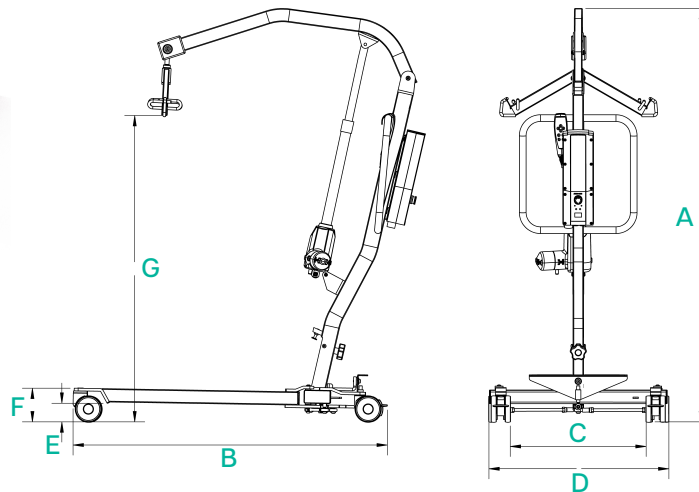

Standards

ISO 10535:2006
 IEC 62366-1:2015
 EN ISO 15223-1:2016
 IEC 60601-1:2012
 IEC 60601-2:2014

This product is CE marked and complies with EU MDR 2017/745

Contact

Unit 4 Jubilee Way
 Grange Moor
 Wakefield
 United Kingdom
 WF4 4TD

+44 (0)1924 840100
 info@prismmedical.co.uk

prismhealthcare



M180 Datasheet

998068A – 08.22

mackworth

M180 – Fixed



Weights and dimensions

SWL	: 180 kg
Unit weight	: 39 kg
A (height)	: 1,340 – 1,970 mm
B (length)	: 1,310 mm
C (internal width)	: 540 – 1,030 mm
D (external width)	: 680 – 1,120 mm
E (ground clearance)	: 25 mm
F (under bed clearance)	: 112 mm
G (Carry bar height)	: 255 – 1,700 mm
Carry bar width	: 560 mm
Turning circle	: 1,010 mm
Castor size	: 100 mm

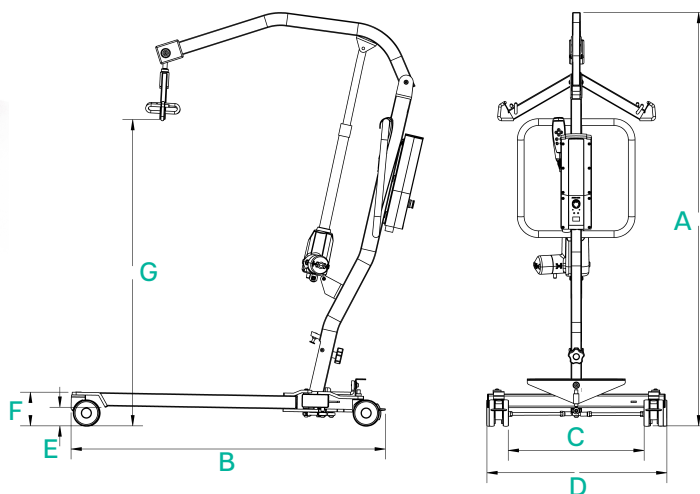

Details

Product code	: 1301MH-M180FIXED
Drawing number	: 107500
GS1 code	: 5056408920148
Warranty	: 2 years
Sling connection	: Looped
Lift	: Electric (LA34 – 10 kN)
Leg opening	: Manual
Duty cycle	: 15% use, 85% rest
Battery	: 24 V SLA, 2.9 Ah
Charging time	: 8 hours
Lifts per charge	: 30
IP rating (controls)	: IPX4
IP rating (battery)	: IPX5
Material	: Powdercoated steel, vinyl PVC

Standards

ISO 10535:2006
 IEC 62366-1:2015
 EN ISO 15223-1:2016
 IEC 60601-1:2012
 IEC 60601-2:2014

This product is CE marked and complies with EU MDR 2017/745

Contact

Unit 4 Jubilee Way
 Grange Moor
 Wakefield
 United Kingdom
 WF4 4TD

+44 (0)1924 840100
 info@prismmedical.co.uk



M180 – Folding (QRS)

Weights and dimensions

SWL	: 180 kg
Unit weight	: 39 kg
A (height)	: 1,340 – 1,970 mm
B (length)	: 1,310 mm
C (internal width)	: 540 – 1,030 mm
D (external width)	: 680 – 1,120 mm
E (ground clearance)	: 25 mm
F (under bed clearance)	: 112 mm
G (Carry bar height)	: 255 – 1,700 mm
Carry bar width	: 560 mm
Turning circle	: 1,010 mm
Castor size	: 100 mm

Details

Product code	: 1301MHQRS107510
Drawing number	: 107510
GS1 code	: 5056408924382
Warranty	: 2 years
Sling connection	: Looped
Lift	: Electric (LA34 – 10 kN)
Leg opening	: Manual
Duty cycle	: 15% use, 85% rest
Battery	: 24 V SLA, 2.9 Ah
Charging time	: 8 hours
Lifts per charge	: 30
IP rating (controls)	: IPX4
IP rating (battery)	: IPX5
Material	: Powdercoated steel, vinyl PVC

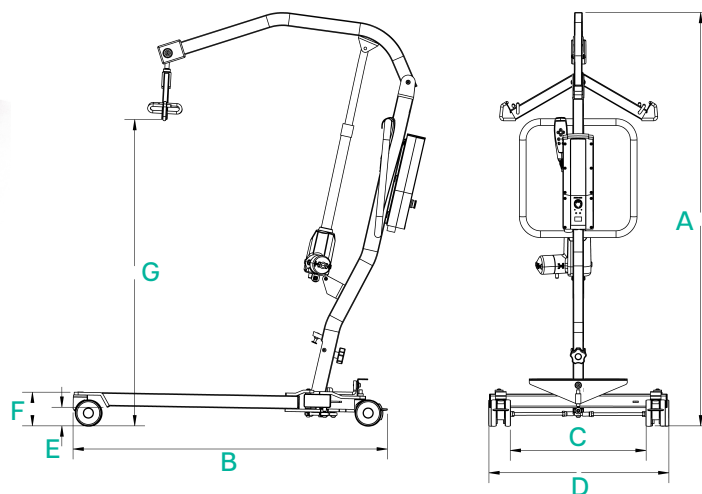

Standards

ISO 10535:2006
 IEC 62366-1:2015
 EN ISO 15223-1:2016
 IEC 60601-1:2012
 IEC 60601-2:2014

This product is CE marked and complies with EU MDR 2017/745

Contact

Unit 4 Jubilee Way
 Grange Moor
 Wakefield
 United Kingdom
 WF4 4TD

+44 (0)1924 840100
 info@prismmedical.co.uk



M180 – Fixed (QRS)

Weights and dimensions

SWL	: 180 kg
Unit weight	: 39 kg
A (height)	: 1,340 – 1,970 mm
B (length)	: 1,310 mm
C (internal width)	: 540 – 1,030 mm
D (external width)	: 680 – 1,120 mm
E (ground clearance)	: 25 mm
F (under bed clearance)	: 112 mm
G (Carry bar height)	: 255 – 1,700 mm
Carry bar width	: 560 mm
Turning circle	: 1,010 mm
Castor size	: 100 mm

Details

Product code	: 1301MHQRS107511
Drawing number	: 107511
GS1 code	: 5056408924399
Warranty	: 2 years
Sling connection	: Looped
Lift	: Electric (LA34 – 10 kN)
Leg opening	: Manual
Duty cycle	: 15% use, 85% rest
Battery	: 24 V SLA, 2.9 Ah
Charging time	: 8 hours
Lifts per charge	: 30
IP rating (controls)	: IPX4
IP rating (battery)	: IPX5
Material	: Powdercoated steel, vinyl PVC

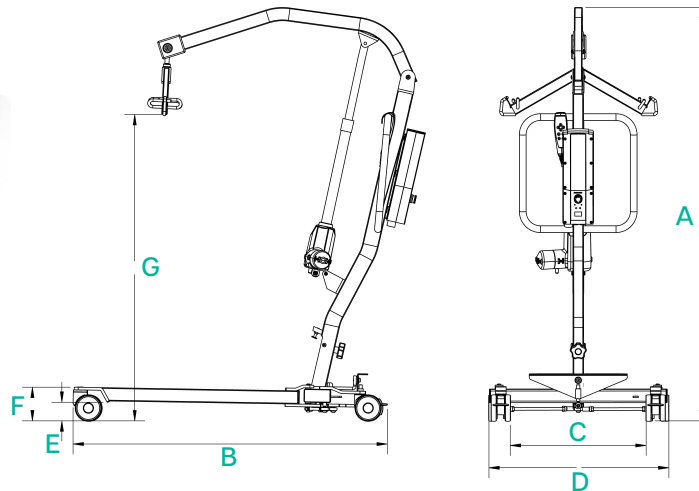

Standards

ISO 10535:2006
 IEC 62366-1:2015
 EN ISO 15223-1:2016
 IEC 60601-1:2012
 IEC 60601-2:2014

This product is CE marked and complies with EU MDR 2017/745

Contact

Unit 4 Jubilee Way
 Grange Moor
 Wakefield
 United Kingdom
 WF4 4TD

+44 (0)1924 840100
 info@prismmedical.co.uk

